



Penal-Ware® 1652FA Series 18" Lavatory with Oval Bowl - ADA 2010 Compliant - Front Access



1652FA-1-BP-04-M-DMB-BP

Fixture May Show Some Available Options

Please visit www.acorneng.com for most current specifications.

18" Lavatory with Oval Bowl - ADA 2010 Compliant - Front Access

Fixture is factory piped, tested and designed to be installed on a finished wall through a removable bottom secured with tamper-resistant screws. Optional Wall Sleeve is recommended to provide wall openings. Lavatory complies with ANSI, UFAS and ADA 2010 requirements for accessibility. Compliance is subject to the interpretation and requirements of the local code authority.

Cabinet is fabricated from 14 gage, type 304 stainless steel and is seamless welded construction with exposed surfaces polished to a satin finish. Cabinet interior is sound-deadened with fire-resistant material.

Lavatory Oval Bowl is 14-3/4" x 9-1/2" x 4-1/2" deep and includes an integral fast drain. Standard P-trap waste outlet is 1-1/2" O.D. plain end and extends 3" beyond the rear of the fixture.

Optional Lavatory Valve is an pneumatically operated, pushbutton Air-Control valve using atmospheric air. Pushbutton is vandal-resistant and requires less than 5 pounds to activate valve. Valve is metering, non-hold open type. Valve timing is adjustable from 5 to 60 seconds. Valve includes a 0.5 GPM flow control and can be remotely located up to 10 feet from the operating pushbutton. Valve and Bubbler conforms with lead free requirements of NSF61, Section 9, 1997 and CHSC 116875.

Regularly furnished items include a fast drain, an integral self-draining soap dish and mounting hardware. Wall anchors by others.

Suffix Option -DMB, Deck Mounted Bubbler optionally available, provides a drinking bubbler that meets ADA requirements and lead free requirements of NSF61, Section 9, 1997, CHSC 116875. This option also includes a separate pushbutton and non-metering Air-Control valve with .7 GPM flow control.

GUIDE SPECIFICATION

Provide and install an Acorn Penal-Ware, 18" wide ADA 2010 Compliant Lavatory with Oval Bowl, Front Access (specify model number and options). Unit shall conform with ANSI, UFAS and ADA requirements for accessibility. Fixture shall be fabricated from 14 gage, type 304 stainless steel. Construction shall be seamless welded and exposed surfaces shall have a satin finish. Countertop shall have an air-circulating, self-draining soap dish. Provide Air-Control pneumatically operated, metering, non-hold open valve with ADA compliant pushbutton. Valve and Bubbler conform with lead free requirements of NSF61, Section 9-1997 and CHSC 116875. Cabinet bottom shall be removable and secured with tamper-resistant screws. Cabinet interior shall be sound deadened with fire-resistant material. Fixture shall be furnished with necessary fasteners for proper installation.

Penal-Ware®: 1652FA 18" Lavatory with Oval Bowl - ADA Compliant - Front Access



WALL THICKNESS AND TYPE (Must Specify)

Thickness: _____ Type: ☐ Concrete ☐ Block ☐ Steel

MODEL AND OPTIONS SELECTION:

BASE MODEL NUMBER

- ☒ 1652-FA 18" Lavatory with Oval Bowl -
ADA Compliant - Front Access

FIXTURE MOUNTING AND WASTE (Must Specify)

- ☒ -1 Off-Floor, Wall Outlet

BUBBLER SELECTION (Must Specify)

- ☐ -BC Bubbler, Code
☐ -BP Bubbler, Penal
☐ -BPH Hemispherical Penal Bubbler
☐ -LF Lav-Filler

VALVE SELECTION (Must Specify)

- ☐ -03-M Air-Control, Single Temp, Metering
☐ -04-M Air-Control, H & C, Metering
☐ -9 Punched for Valve by Others
(Specify Punching)
☐ -EVS1 Electronic Valve System - Single Temp
☐ -EVSP1 Electronic Valve Sys. w/ Piezo Pushbutton
☐ -EVS2 Electronic Valve System - Hot & Cold
☐ -EVSP2 Electronic Valve Sys. w/ Piezo Pushbuttons
☐ -MVC1 Time-Trol - Single Temp
☐ -MVC1-BAT Time-Trol - Single Temp
Battery Operation (Batteries Not Included)
☐ -MVC2 Time-Trol - Hot & Cold
☐ -MVC2-BAT Time-Trol - Hot & Cold
Battery Operation (Batteries Not Included)
☐ -PPZ1 Programmable Piezo Button - Single Temp
☐ -PPZ2 Programmable Piezo Button - Hot & Cold

PRODUCT OPTIONS (Must Specify)

- ☐ -BRS Brass Body Valve
☐ -CI Cycle Interrupt for Time-Trol Valves
☐ -DMB Deck Mounted Bubbler (cold water only)
Not applicable with -03-M tempered supply
☐ -BP Penal Style ☐ -BC Code Style
Enviro-Glaze, Specify Color: _____
☐ -EG
☐ -FMT Fixture Mounted Trim
☐ -LWE Lavy Waste Extension (3" Standard)
Specify Length Beyond Fixture: _____
☐ -MT Metal Template (Only 1 Required Per Project)
☐ -OF Lavatory Overflow
☐ -PBH Hemispherical Pushbutton
☐ -SW Wall Sleeve
☐ -TB Toothbrush Holder ☐ Left ☐ Right
☐ -TF Transformer (for up to 12 solenoids)
☐ -TG 12 Gage Cabinet
☐ -TH Towel Hook
Left Side: ☐ Single ☐ Double
Right Side: ☐ Single ☐ Double
☐ -VAC Acorn-Vac System

Please visit www.acorneng.com
for most current specifications.

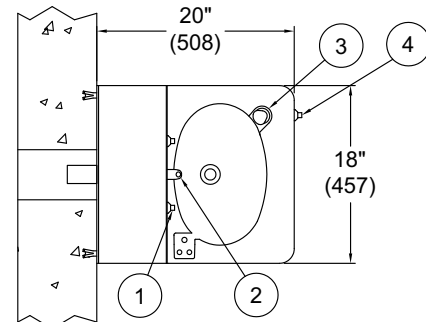
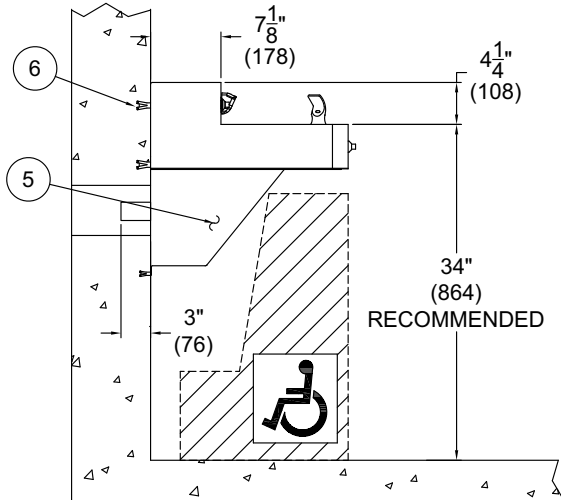

NOTES:

1. Lavy Valve Pushbuttons.
2. Lavy Bubbler.
3. Optional -DMB Deck Mounted Bubbler.

4. Optional Bubbler Pushbutton for (-DMB).
5. Removable Access Panel.
6. Wall Mounting Anchors (By Others).

1652-ADA-FA-1-BP-04-DMB

Important: Installation instructions and current rough-in are furnished with each fixture. Do not rough in without certified dimensions. Dimensions are subject to manufacturer's tolerance of plus or minus 1/4" and change without notice. Acorn assumes no responsibility for use of void or superseded data. © Copyright 2009 Acorn Engineering Company	
Selection Summary Model No. & Option _____ Quantity _____	Approved for Manufacturing Company _____ Title _____ Signature _____ Date _____